

NEW!



SEGWAY®

E110 ACCESSORIES



**INCREASES E110A RANGE FROM
35 TO 60 MILES!**

**ADDITIONAL BATTERY KIT
(LONG RANGE E110A)**



**FOLDING REAR RACK WITH
PASSENGER BACKREST**



**INCREASED CARRYING CAPACITY
& ADDED PASSENGER COMFORT!**

CELL PHONE HOLDER



**A SAFE PLACE FOR YOUR PHONE
& GREAT FOR NAVIGATION!**



E110A ADDITIONAL BATTERY KIT

Additional E110A Battery Kit AC.50.0001.69

- Increase range from 35 to 60 miles
- Includes jumper wiring harness that allows batteries to run in parallel to charge and discharge at the same time
- The second battery goes in the floorboard (Low center of gravity and retains truck capacity)

Battery

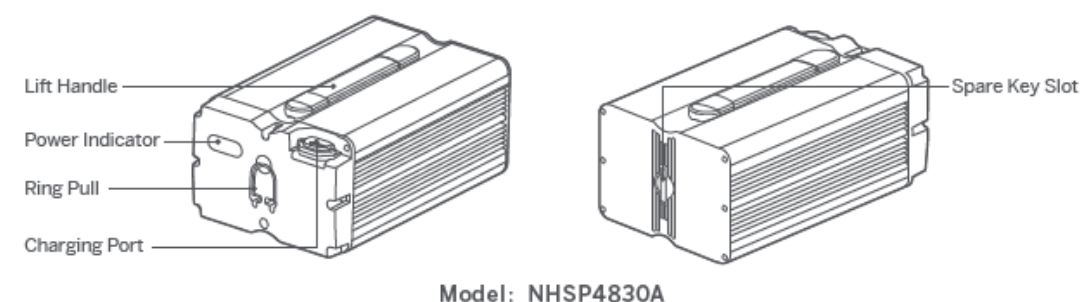

Accessories

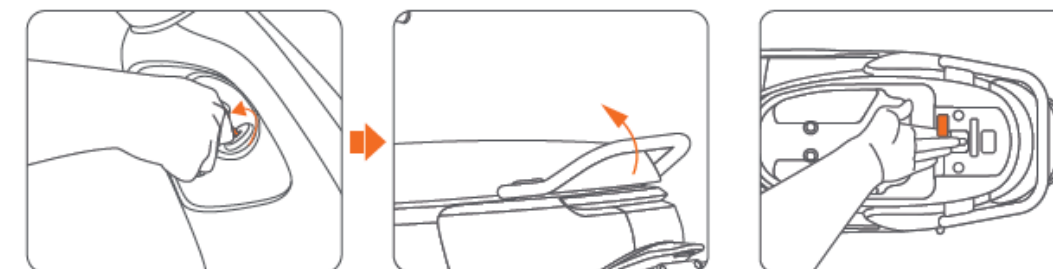
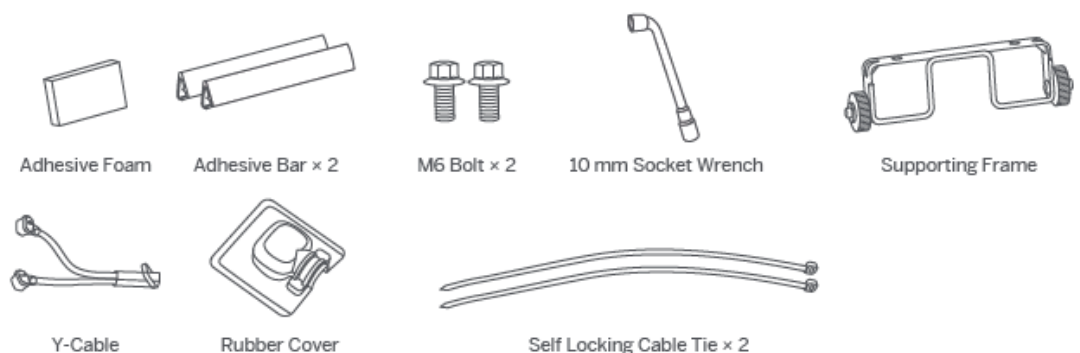

3. Lift the lid.

4. Unplug the default battery and take it out.

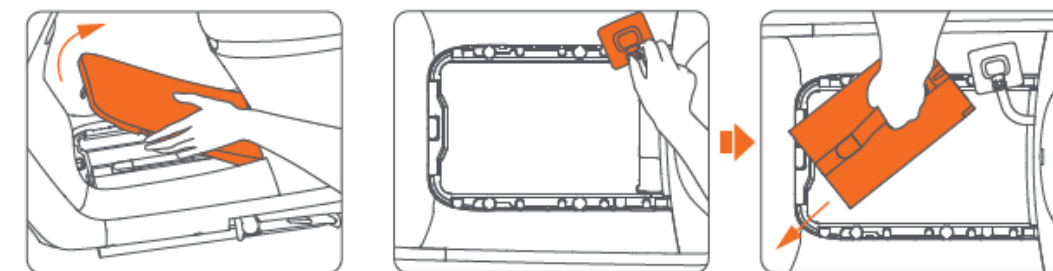

5. Apply a little pressure to the center of the plastic rivets with a screwdriver or a sharp-pointed tool to loosen them up. Pull them out and remove the partition panel.

6. Remove the 4 screws on the inside with the 10 mm socket wrench (counterclockwise).

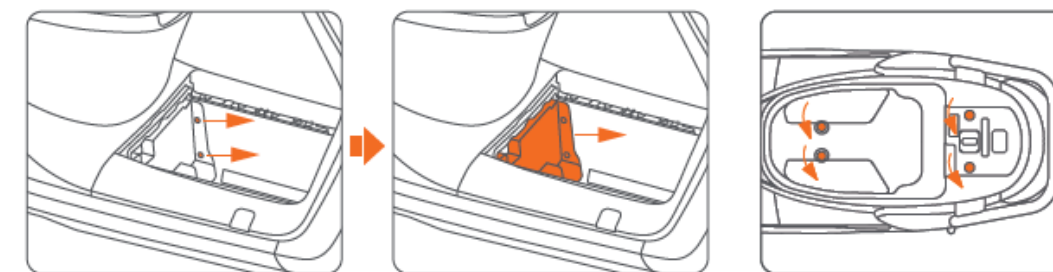

MSRP \$999.99

Make your E110A a Long Range E110A



**INCREASES E110A RANGE FROM
35 TO 60 MILES!**



Scan the QR code to
watch the instruction video.



E110A FOLDABLE REAR RACK WITH BACKREST

Foldable Rear Rack With Backrest AC.50.0000.17

- Increase carrying capacity
- Add passenger comfort



MSRP \$99.99

Add Comfort & Convenience





E110A CELL PHONE HOLDER

Cell Phone Holder AC.50.0000.39

- A safe place for you phone while riding
- Mounts in-conjunction with mirror mount
- Made of premium materials Aluminum Alloy and Polycarbonate



MSRP \$29.99

Keep your phone safe and visible

